

PART LIST

CODE	DESCRIPTION	MATERIAL	Q.TY
Y-S0012	Right	Plastic	1
Y-S0014	Cheekplate	Plastic	1
Y-S0006	Threaded pipe	Chromed brass	1
Y-S0013	Cheekplate	Plastic	2
Y-X0004	Screw	S.Steel	2
Y-S0007	Pipe spacer	Chromed brass	2
Y-X0006	Screw	S.Steel	4
Y-SA004	Base module	Various	3
Y-SA003	Lever assy	Various	3
Y-S0004	Base	Aluminium	3

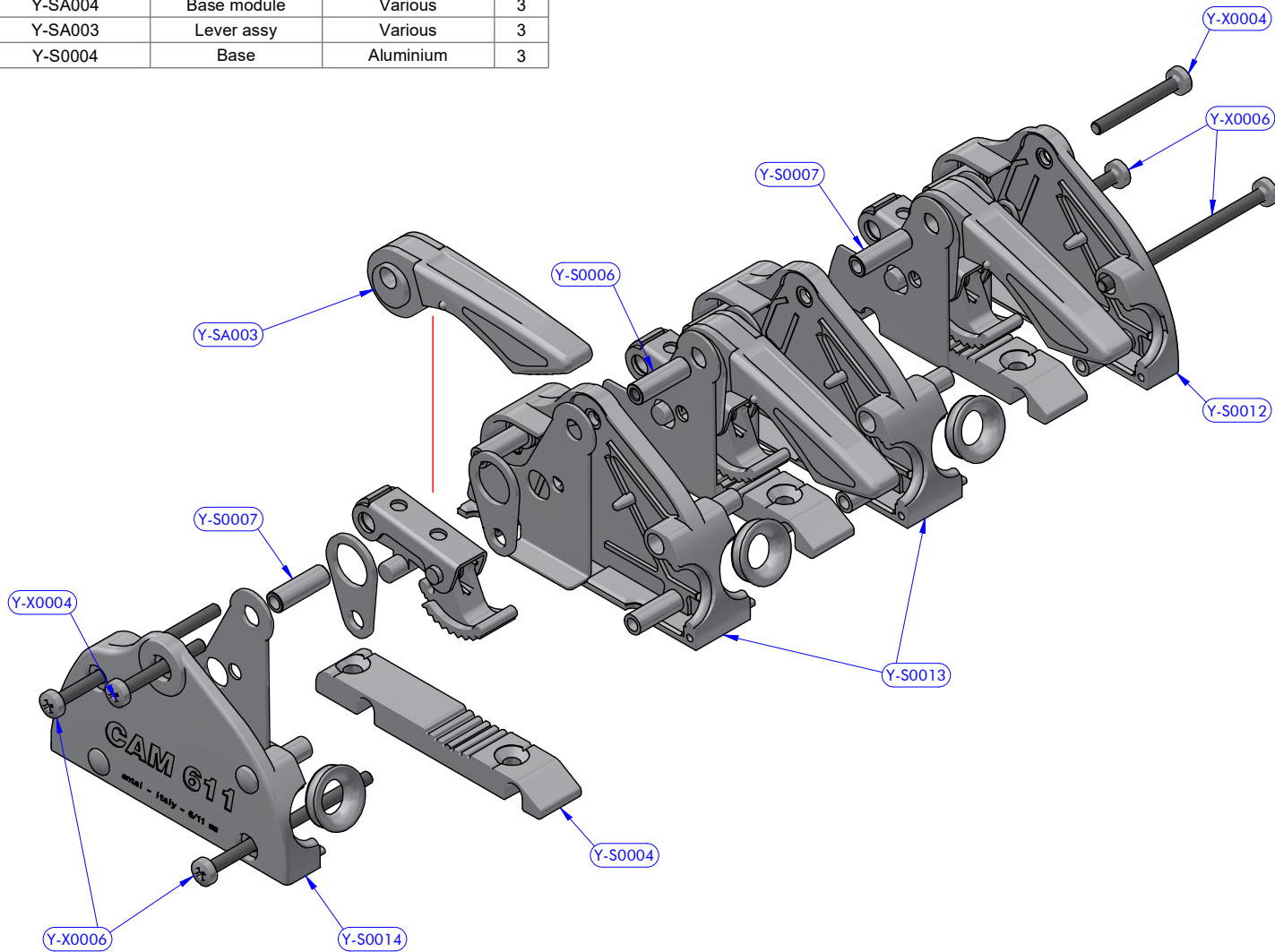

Cod.Y-SA004
Base module

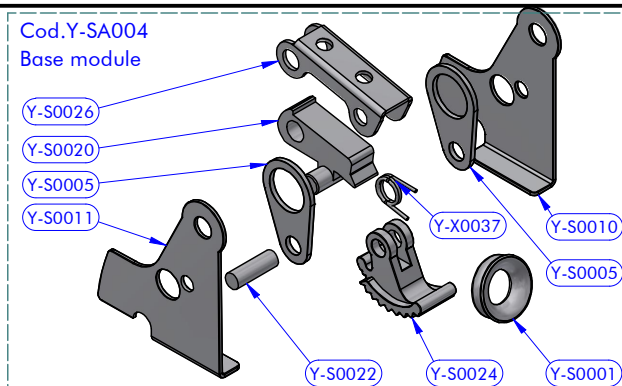

Cod.Y-SA003
Lever assy

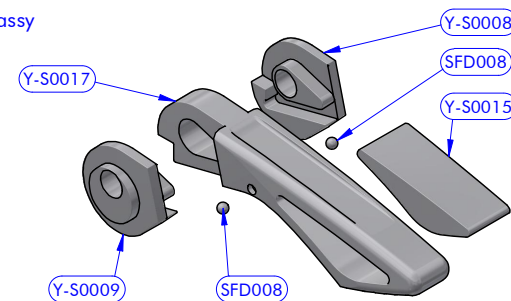

PART LIST - Y-SA004

CODE	DESCRIPTION	MATERIAL	Q.TY
Y-S0010	Reinforcement plate	S.Steel	1
Y-S0011	Reinforcement plate	S.Steel	1
Y-S0005	Connecting rod	Aluminium	2
Y-S0026	Cam bracket	S.Steel	1
Y-S0024	Cam-cleat	Chromed brass	1
Y-S0020	Cam bracket	Plastic	1
Y-X0037	Torsion spring	S.Steel	1
Y-S0022	Cylinder pin	S.Steel	1
Y-S0001	Ring	Chromed brass	1

PART LIST - Y-SA003

CODE	DESCRIPTION	MATERIAL	Q.TY
SFD008	Delrin ball	Plastic	2
Y-S0008	Cam	Plastic	1
Y-S0009	Cam	Plastic	1
Y-S0015	Insert	Plastic	1
Y-S0017	Lever	Aluminium	1

antal

Clutch CAM 611 Triple Silver Handle

543.130

11/05/2023

00

DATE

REV.

23042711

1 / 1

DWG N.

PG.

DESCRIPTION

MODEL CODE